

NDIS Hub

The operating system for NDIS providers — participants, invoicing on the latest price guide, rosters, progress notes and an AI assistant in one calm dashboard.

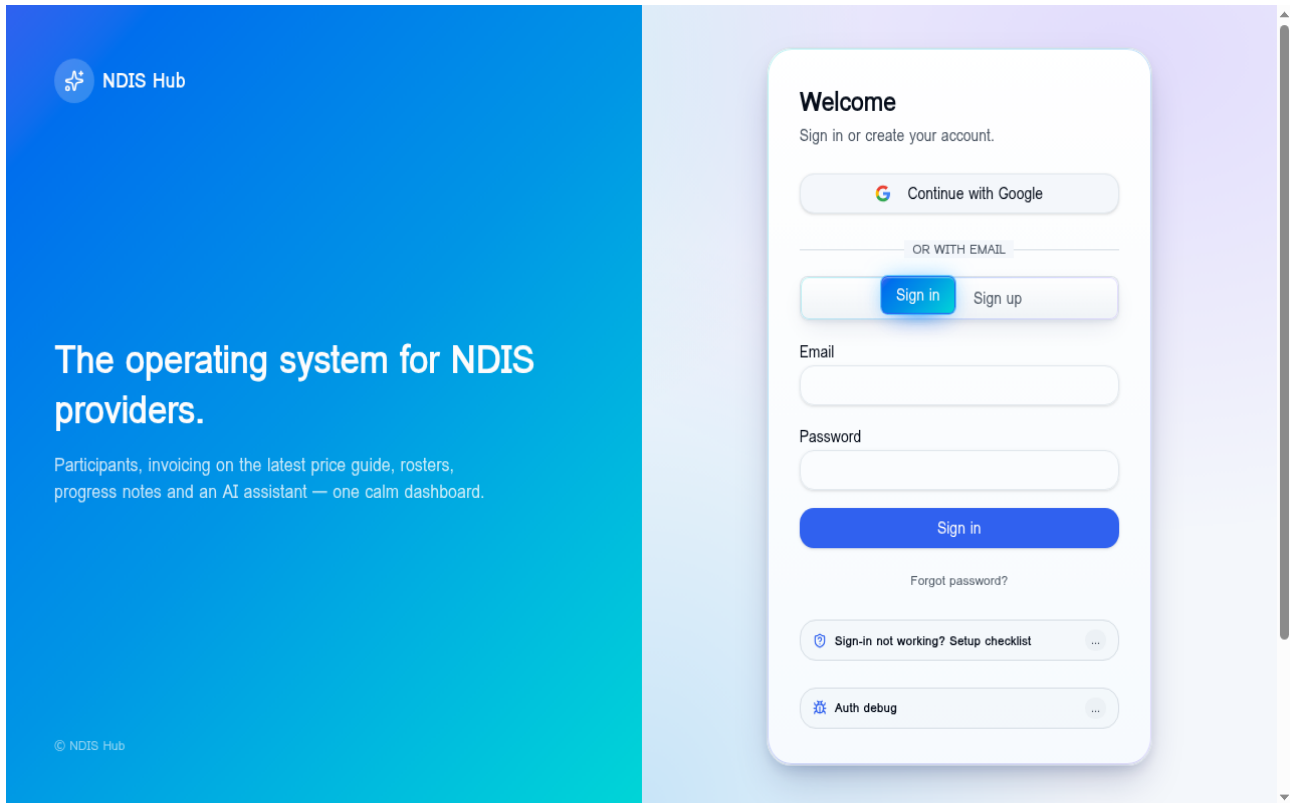

Branded sign-in with Google or email/password.

Welcome

This guide walks new NDIS providers through what NDIS Hub does, how the core workflows fit together, and how to get set up. The whole platform is designed around three goals: reduce admin time, keep participant records compliant, and make invoicing painless.

You can run NDIS Hub in any modern browser, or install it to your home screen for a native-app experience on iPhone, iPad, Android and desktop.

WHAT'S INSIDE

Core features

Every module shares the same participant, roster and invoice data — so a shift you log on Monday becomes an invoice line item on Friday without any retyping.

Participants register

Keep every participant's plan, NDIS number, budget and notes in one secure place. Status tags surface who's active, paused or off-boarded at a glance.

Smart invoicing

Generate compliant invoices from completed shifts in seconds. Auto-populates the latest NDIS price guide, calculates GST, and exports clean PDFs ready to email or upload to a plan manager.

Upload & auto-fill (AI)

Drop in a PDF or photo of an existing invoice and the AI parses participant, line items and totals — turning paperwork into a draft you only need to review.

Rosters & shifts

Schedule support workers against participants, track service codes, and convert completed shifts straight into invoice line items. No double-entry.

Progress notes

Date-stamped notes per participant covering goals, activities and outcomes. Filter, search, and export for plan reviews.

Reminders & calendar

Recurring reminders for plan reviews, reassessments and renewals. Optional email pings so nothing slips through.

AI assistant

A conversational helper that can summarise invoices, draft progress notes, surface budget warnings, and answer questions about your data — with permissions you control.

Reports & GST

One-click monthly summaries and GST exports. Send straight to your accountant or download as CSV/PDF.

Install as an app

Add NDIS Hub to your phone or tablet home screen for a full-screen, offline-capable experience — no app store required.

Privacy & audit log

Row-level security on every record, a complete invoice audit trail, and admin tooling for auth and access — built for sensitive participant data.

Pricing that scales with your practice

Start on Starter for solo coordinators, move to Growth when you add support workers and the AI assistant, and unlock unlimited everything on Scale. Annual billing saves around 17%.

NDIS Hub Pricing [Sign in](#)

Simple, transparent pricing

Pick the plan that fits your practice

Save ~17% with annual billing. Cancel any time — you keep read-only access until the end of the period.

[Monthly](#) [Yearly — save ~17%](#)

Starter	Growth <small>most popular</small>	Scale
\$49 AUD/mo	\$99 AUD/mo	\$199 AUD/mo
<ul style="list-style-type: none">✓ Up to 10 active participants✓ 2 support worker seats✓ 50 invoices / month✓ NDIS price guide line items✓ Invoice PDF + email	<ul style="list-style-type: none">✓ Up to 50 active participants✓ 10 support worker seats✓ 500 invoices / month✓ AI assistant✓ Advanced reporting	<ul style="list-style-type: none">✓ Unlimited participants✓ Unlimited support workers✓ Unlimited invoices✓ SMS reminders✓ Priority support
Get started →	Get started →	Get started →

Starter, Growth and Scale plans — monthly or yearly.

Your first 30 minutes

1. Create your account

Sign up with Google or email. Confirm your email address and you'll land on a clean dashboard.

2. Set up your business profile

Add your ABN, business name, contact details and logo. These appear on every invoice you issue.

3. Add your first participants

Enter NDIS numbers, plan dates and budgets. You can paste in details from existing spreadsheets.

4. Add support workers and roles

Invite workers and assign role permissions (admin, manager, support worker).

5. Schedule your first shift

Use the rosters view to schedule a shift against a participant, with the matching NDIS service code.

6. Generate your first invoice

From completed shifts, click Create invoice — the line items, GST and total are pre-filled.

7. Install on your phone

Open the Install guide and add NDIS Hub to your home screen for instant access.

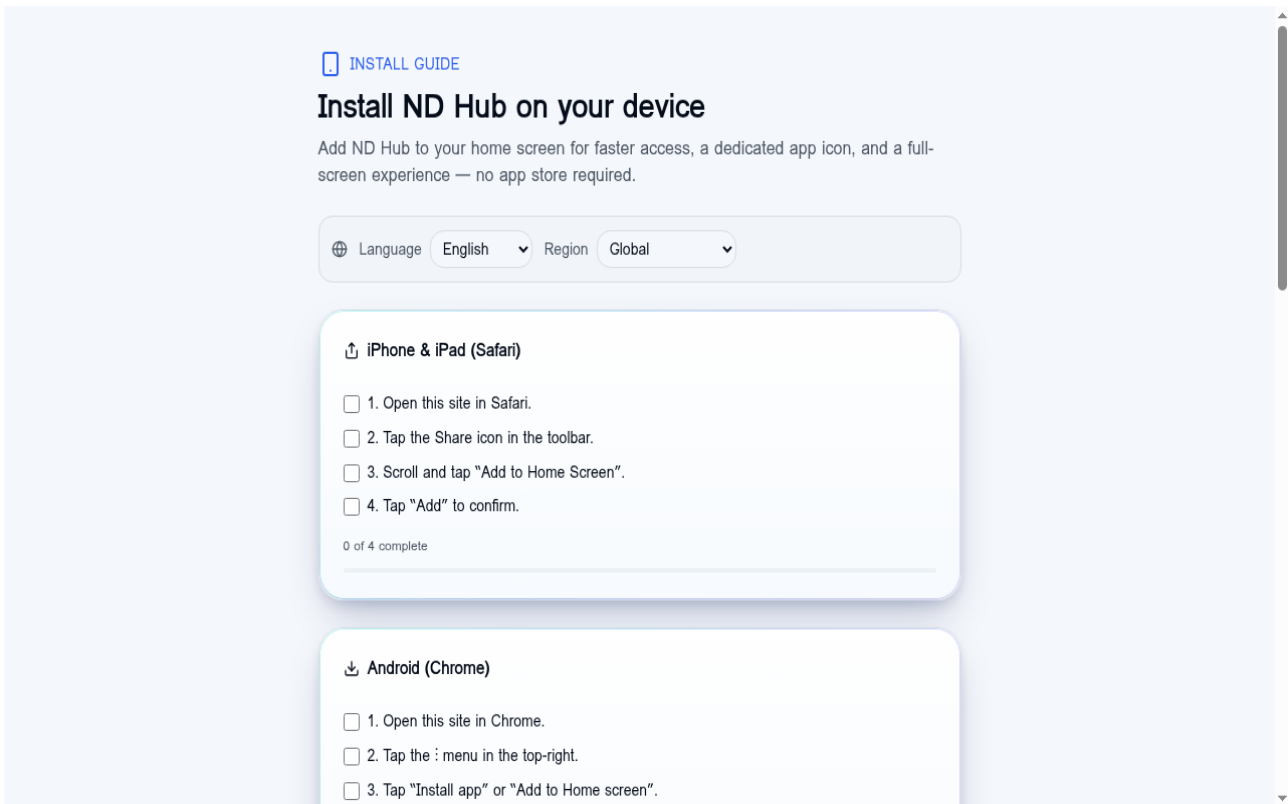

Step-by-step install guide for iOS, Android and desktop.

NEXT STEPS

Need a hand?

Email support from inside the app, or browse the in-product help. Admin users also get access to a publish checklist, build health dashboard and audit logs to keep an eye on the system.

Plan	Best for	Highlights
Starter — \$49/mo	Solo coordinators	10 participants, 50 invoices/mo
Growth — \$99/mo	Small teams	50 participants, AI assistant, advanced reports
Scale — \$199/mo	Established providers	Unlimited participants, SMS reminders, priority support